

6 | Floorplans - Permitted and Proposed

Level B2 - Permitted

Permitted

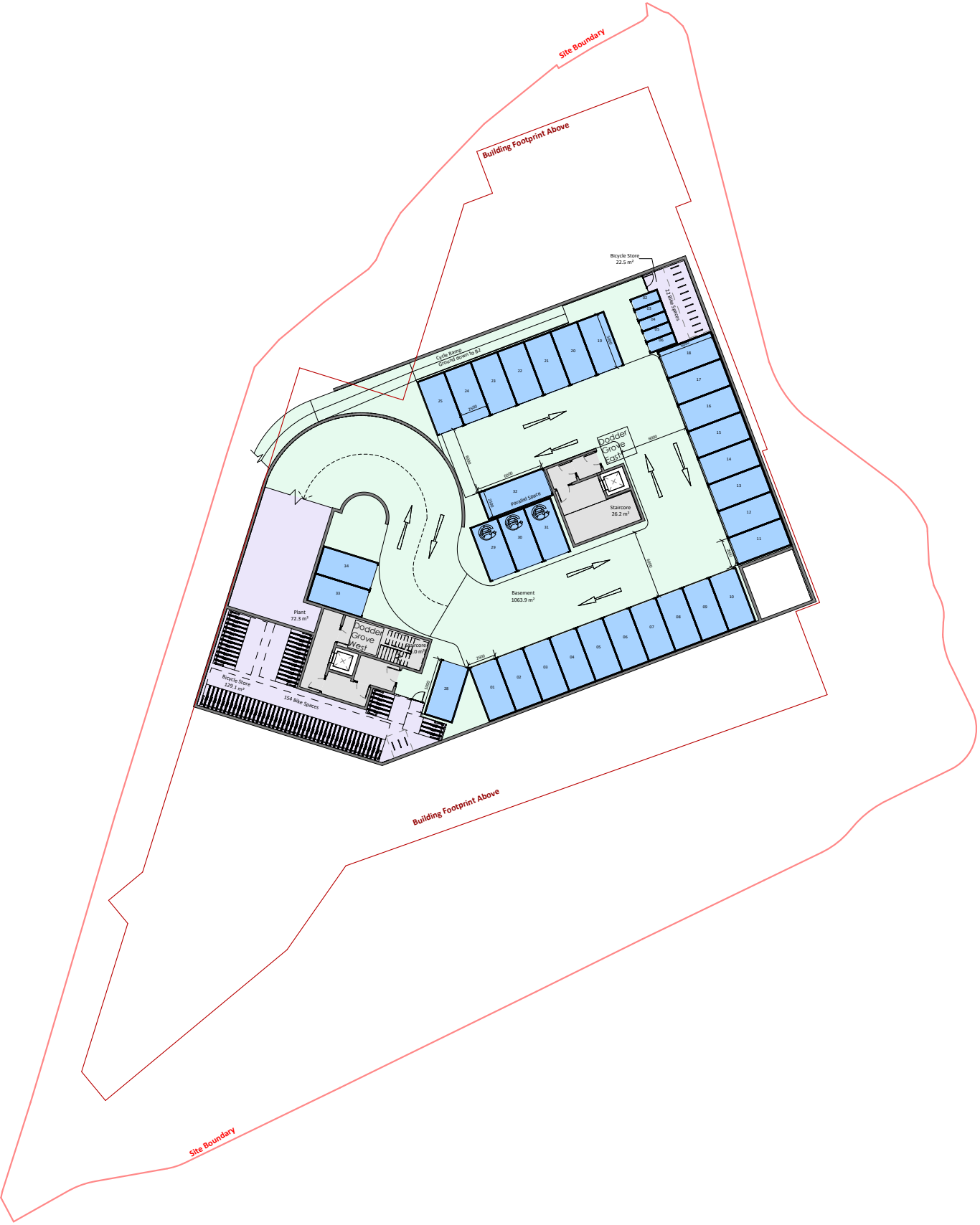

Level B2 - Proposed

- Revised Core and Plant arrangements based on detail design including Fire / DAC strategy and M&E requirements
- Reconfiguration of car/motorbike parking layout
- Rationalization of Bicycle access route by removing the separate access ramp. Bicycle spaces reduced from 176no. to 149no. at level B2.
- Relocation of Plant and an uplift in plant area proposed



Proposed

6 | Floorplans - Permitted and Proposed

Level B1 - Permitted



Permitted

Level B1 - Proposed

- Revised Core and Plant arrangements based on detail design including Fire / DAC strategy and M&E requirements
- Reconfiguration of car/motorbike parking layout
- Bicycle spaces omitted below access ramp following detail design of the permitted scheme and infrastructural advice
- Relocation of Plant and an uplift in plant area proposed based on detail design of the permitted scheme



Proposed

6 | Floorplans - Permitted and Proposed

Level 00 - Permitted



Permitted

Level 00 - Proposed

- Southern end of B01 reconfigured to reduce the number of studio apartments and reduce corridor length.
- Northern end of B01 reconfigured for fire safety, structural and ESB substation requirements.
- Balconies along eastern facade rationalised for ease of construction.
- Apartments entrance to B02 adjusted.
- Commercial units in B02 rationalised.
- Surface parking proposed to satisfy requirements of commercial unit tenants.



Proposed

Level 01 - Permitted



Permitted

Level 01 - Proposed

- Northern end of B01 reconfigured for fire safety, structural and ESB substation requirements.
- Balconies along eastern facade rationalised for ease of construction.
- Southern core of B02 reorientated and corridor length reduced to satisfy fire safety requirements and facilitate ease of construction.
- Form of both blocks rationalised for ease and efficiency of construction and to provide a more coherent architectural form.
- Apartment mix of GA layout adjusted- 3bed unit relocated to this level.



Proposed

Permitted

